

| 1. GATEWAY & BRIDGE SERIES

1.7 Salto Bridge, 4 Locks S04HOST

2. Dimming Series
3. Relay Series
4. Climate Series
5. Guest Room Series
6. Human Interface Series
7. I/O Series
8. Power Supply Series
9. Multiroom Audio Series
10. Motorization Series



I DESCRIPTION

The GreenIoT CONTROLS (GreenIoT) S04HOST Salto Bridge, 4 Locks is a 2-way protocol communication converter which is used to connect between the GreenBUS and the Salto host module of the Sallis Access Control System.

The basic operation of the gateway is to pass data between the GreenBUS and the Sallis Access Control System allowing operation from other devices connected to the GreenBUS system.

It has an LED indicator (green) to show the status of the device during operation.

Additionally, it allows monitoring of states changes. It also incorporates advanced control features of Timers and Events via its built-in Event engine which supports up to 32 Events. Each event can include up to 8 triggers, 8 conditions and 128 actions.

| DEVICE FEATURES

LED status indicator (green), which can indicate the status of the device operation.

RS485 communication interface with selectable baud rate.

Supports Timer and Event control.

Supports up to 4 Locks with up to 64 User RFID tags.

Built-in Event engine supporting up to 32 Events with up to 8 triggers, 8 conditions and 128 actions.

32 Flags can be defined to be used as triggers and/or conditions for Event engine.

Built-in Timer engines supporting up to 16 Timers.

Support all GreenBUS functions.

Programmable onsite or offsite via Smart IoT CONTROLS Configuration Client Software.

Programmed variables are stored in nonvolatile memory and are retained in case of loss of mains or GreenBUS power.

Supports local and online upgrade.

CE & RoHS compliant.

I TECHNICAL SPECIFICATIONS

Operation Voltage:	DC 24V ±10% (BUS Powered)
Power Consumption:	20mA ±10%
Working Temperature:	0°C ~ +55°C
Storage Temperature:	-10°C ~ +55°C
Working Humidity:	20% ~ 90%
Storage Humidity:	10% ~ 90%
Installation:	Inline
Color:	Grey
Module Dimension:	13x46x40mm(WxHxD)
Packing Dimension:	35x55x50mm (WxHxD)
Net Weight:	20g
Gross Weight:	25g
Operation and Display:	Green LED, displaying the physical status
CE Mark:	In accordance with EMC and LVD
Protection Class:	IP20, EN60 529

I DIMENSIONS

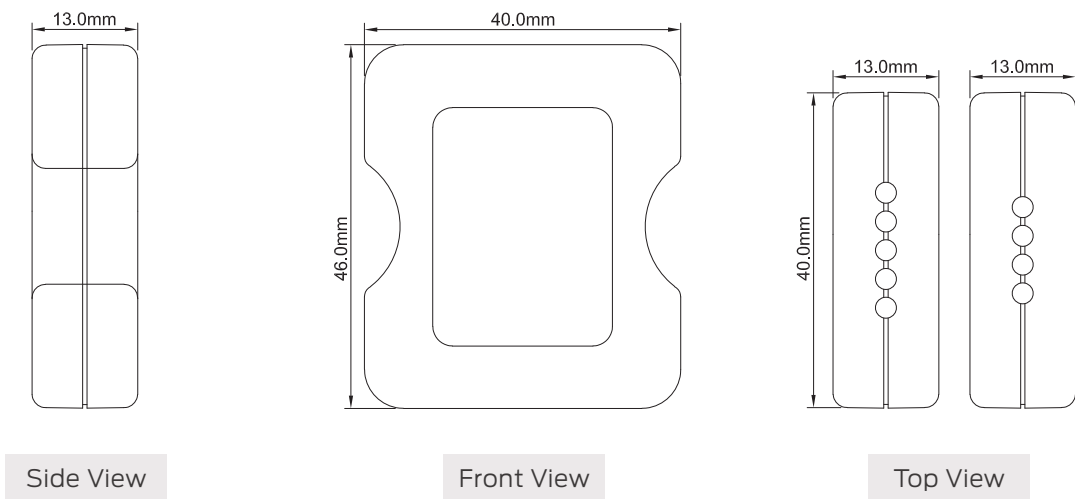

I INSTALLATION

Step 1: Option 1

The device can be installed in numerous locations and its small and compact design makes it ideal for installation into in-wall or surface mounted back boxes (see [Figure 1](#)).

Step 1: Option 2

Additionally, other installation methods are allowed as required by the solution's design.

Step 2:

Wire remaining terminals in accordance with wiring diagram (see [Figure 2](#)).

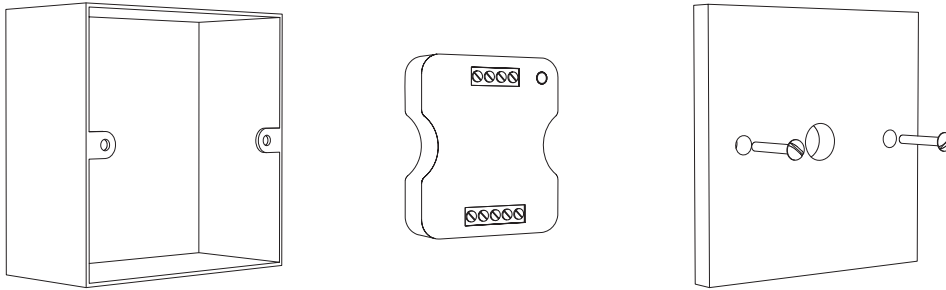

Figure 1

WIRING DIAGRAM

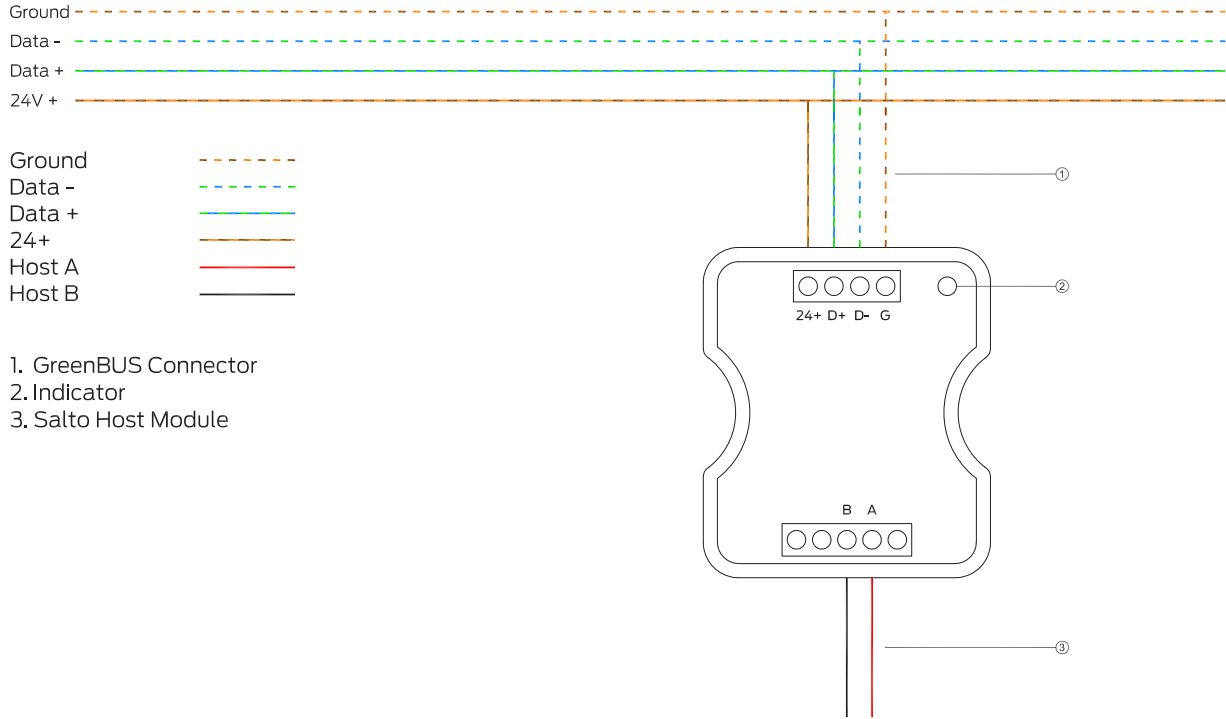

Figure 2: Wiring Diagram

RECOMMENDED CABLES

Module power input cable:

2.0mm² electrical copper wire.

Load output wire:

2.0mm² electrical copper wire.

Recommended cable configuration:

GND = Brown and White + Orange and White

B-(B)= Blue and White + Green and White

B+(A)= Blue + Green

24V = Brown + Orange

