

1. Gateway & Bridge Series
2. Dimming Series
3. Relay Series
4. Climate Series
5. Guest Room Series
6. Human Interface Series

| 7. I/O SERIES

7.5 Bell Press Tapper 2CH DIO122S

8. Power Supply Series
9. Multiroom Audio Series
10. Motorization Series



I DESCRIPTION

The Green IoT CONTROLS (Green IoT) DIO122S Bell Press Tapper 2CH is a device that allows tapping into volt free digital output like any bell press type buttons usually found on many devices like door station.

This allows the integration of such standalone devices that don't provides any sort of integration features.

Making this compact device very powerful in bring many devices to be part of the GreenBus system.

| DEVICE FEATURES

Provides 1 x digital input channel.

Provides 2 x digital output channels.

Compact design for convenient installation.

Provides integration with door station, security, safety systems and many others.

CE & RoHs certified.

TECHNICAL SPECIFICATIONS

Operation Voltage:	DC 24V ±10% (BUS Powered)
Power Consumption:	15mA ±10%
Channel:	1 Digital input (dry contact), 2 Digital outputs
Working Temperature:	0°C ~ +55°C
Storage Temperature:	-10°C ~ +55°C
Working Humidity:	20% ~ 90%
Storage Humidity:	10% ~ 90%
Color:	Grey
Installation:	Back box or Others
Device Dimension:	40x46x13mm (WxHxD)
Packing Dimension:	50x55x35mm (WxHxD)
Net Weight:	20g
Gross Weight:	32g
CE Mark:	In accordance with EMC and LVD
Protection Class:	IP20, EN60 529

DIMENSIONS

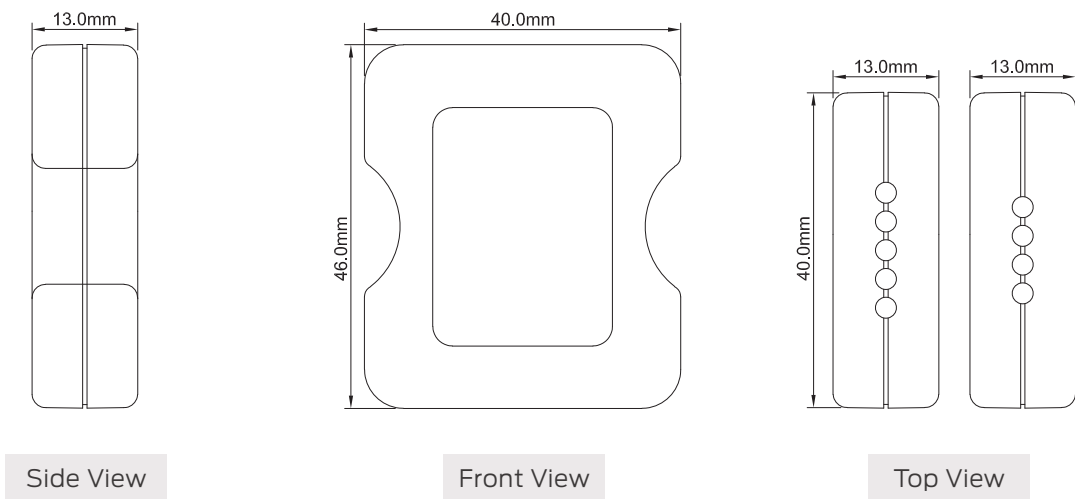

I INSTALLATION

Step 1: Option 1

The device can be installed in numerous locations and its small and compact design makes it ideal for installation into in-wall or surface mounted back boxes (see Figure 1).

Step 1: Option 2

Additionally, other installation methods are allowed as required by the solution's design.

Step 2:

Wire remaining terminals in accordance with wiring diagram (see Figure 2).

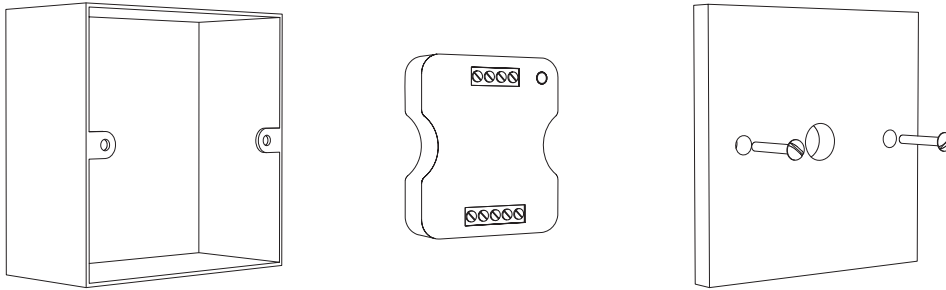

Figure 1

WIRING DIAGRAM

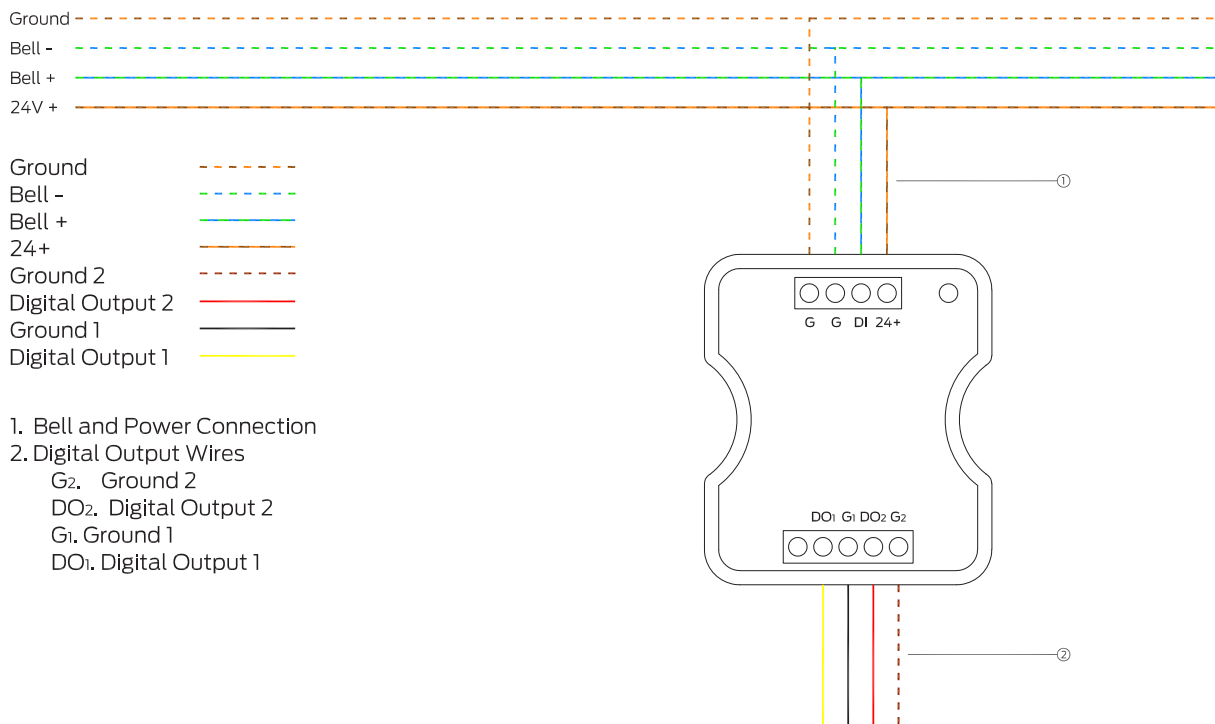

Figure 2: Wiring Diagram

RECOMMENDED CABLES

Module power input cable:

2.0mm² electrical copper wire.

Load output wire:

2.0mm² electrical copper wire.

Recommended cable configuration:

- GND = Brown and White + Orange and White
- B-(B)= Blue and White + Green and White
- B+(A)= Blue + Green
- 24V = Brown + Orange

