

1. Gateway & Bridge Series
2. Dimming Series
3. Relay Series
4. Climate Series
5. Guest Room Series
6. Human Interface Series

---

## **| 7. I/O SERIES**

### **7.4 Digital Input Module 4CH** DIO401S

---

8. Power Supply Series
9. Multiroom Audio Series
10. Motorization Series



## I DESCRIPTION

The Green IoT CONTROLS (Green IoT) DI0401S Digital Input Module 4CH is a GreenBUS I/O device used for connecting up to 4 devices to the GreenBUS system.

This device is small enough to be installed in most standard light switch back boxes. This allows the use of standard light switches (3rd party) and other digital outputs such as door/window contacts, flood, pressure and motion sensors.

It allows the control of lighting, curtains, climate control, audio, media devices, security and many others.

Additionally, and aside from controlling individual channels it allows group control of Zone and Category.

It also incorporates advanced control features of Scene, Sequence, Timer and Event.

## | DEVICE FEATURES

Provides 4 x digital input channels.

Provides connection of non-GreenBUS devices to the GreenBUS.

Small and compact to allow installation behind a standard light switch back box.

Works in multiple operation modes like NO, NC, generic, button and motion sensor.

Provides integration with security and safety systems.

Supports Zone, Category, Scene, Sequence, Timer and Event control.

Up to 512 actions can be stored.

Incorporates Zone and Category grouping.

Built-in Timer engines supporting up to 16 Timers.

Built-in Event engine supporting up to 32 Events with up to 8 triggers, 8 conditions and 128 actions.

32 Flags can be defined to be used as triggers and/or conditions for Event engine.

Programmable onsite or offsite via Smart IoT CONTROLS Configuration Client Software.

Programmed variables are stored in nonvolatile memory and are retained in case of loss of mains or GreenBUS power.

Supports online upgrade.

CE & RoHS certified.

## TECHNICAL SPECIFICATIONS

Operation Voltage:	DC 24V ±10% (BUS Powered)
Power Consumption:	20mA ±10%
Channel:	4 Digital inputs (dry contact)
Working Temperature:	0°C ~ +55°C
Storage Temperature:	-10°C ~ +55°C
Working Humidity:	20% ~ 90%
Storage Humidity:	10% ~ 90%
Color:	Grey
Installation:	Back box or Others
Device Dimension:	40x46x13mm (WxHxD)
Packing Dimension:	50x55x35mm (WxHxD)
Net Weight:	20g
Gross Weight:	32g
Operation and Display:	Green LED, for displaying the physical status
CE Mark:	In accordance with EMC and LVD
Protection Class:	IP20, EN60 529

## DIMENSIONS

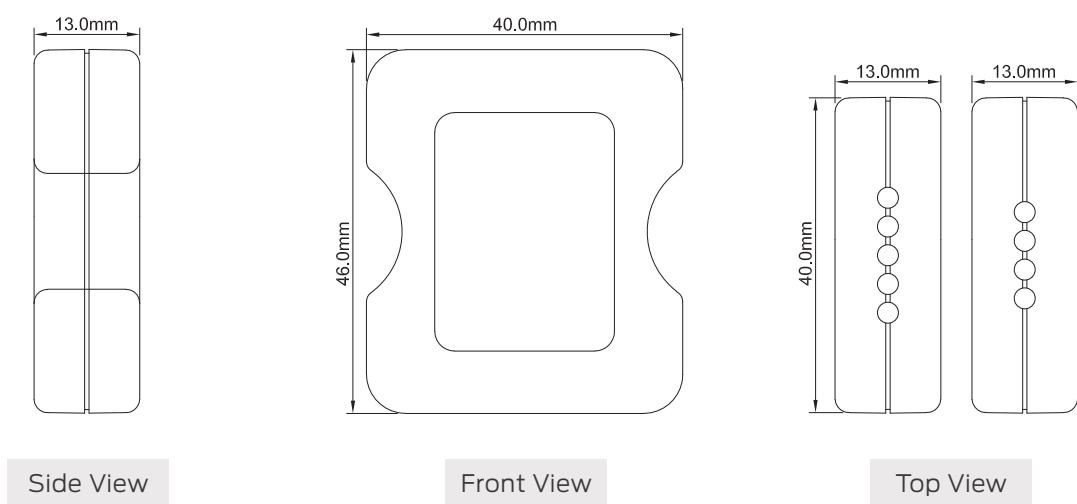

## I INSTALLATION

---

### Step 1: Option 1

The device can be installed in numerous locations and its small and compact design makes it ideal for installation into in-wall or surface mounted back boxes (see [Figure 1](#)).

### Step 1: Option 2

Additionally, other installation methods are allowed as required by the solution's design.

### Step 2:

Wire remaining terminals in accordance with wiring diagram (see [Figure 2](#)).

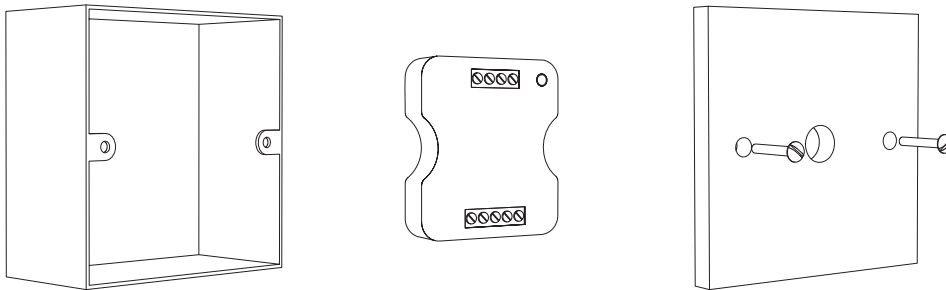
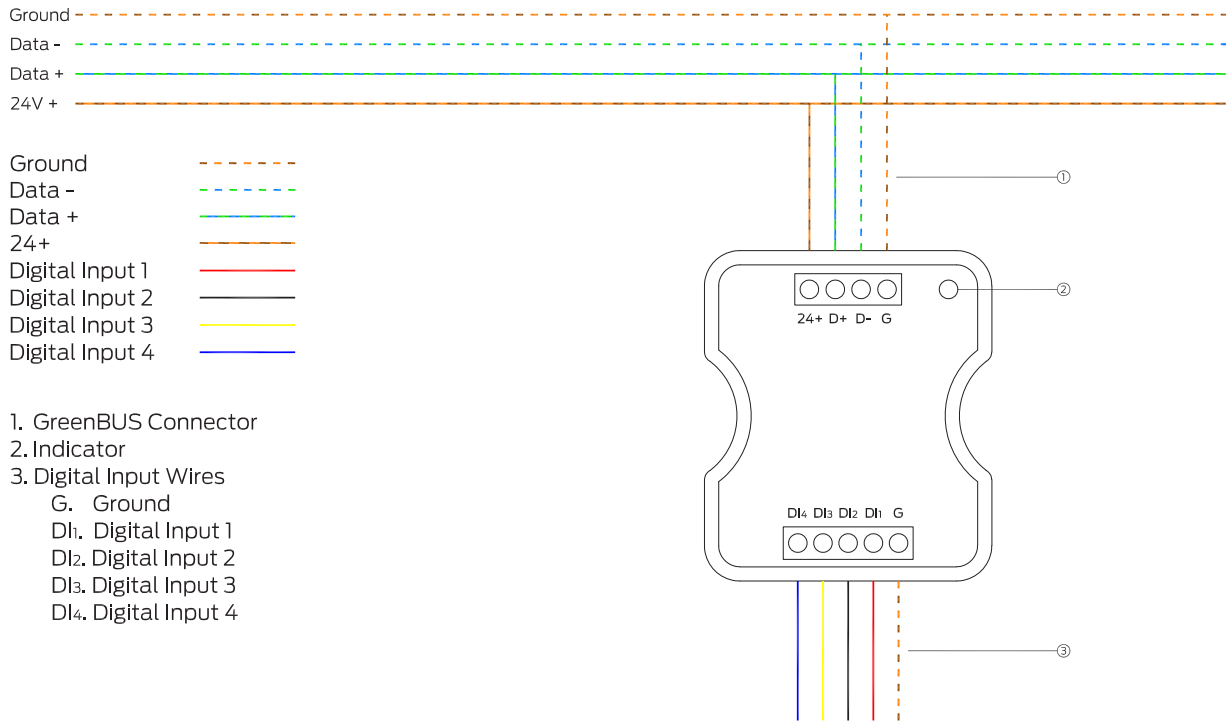

Figure 1

# WIRING DIAGRAM



**Figure 2:** Wiring Diagram

# RECOMMENDED CABLES

**Module power input cable:**

2.0mm<sup>2</sup> electrical copper wire.

**Load output wire:**

2.0mm<sup>2</sup> electrical copper wire.

**Recommended cable configuration:**

GND = Brown and White + Orange and White

B-(B)= Blue and White + Green and White

B+(A)= Blue + Green

24V = Brown + Orange

