

1. Gateway & Bridge Series
2. Dimming Series
3. Relay Series
4. Climate Series
5. Guest Room Series
6. Human Interface Series

| 7. I/O SERIES

7.3 Digital Output Module 2CH DO0201S

8. Power Supply Series
9. Multiroom Audio Series
10. Motorization Series



I DESCRIPTION

The Green IoT CONTROLS (Green IoT) DO0201S Digital Output Module 2CH a GreenBUS voltage free output device.

The device is provided with a status LED to identify the module during system configuration.

It is compact in design for in back box or ceiling installation.

The digital output module allows integration with the third party devices such as voltage free projector screen, projector lift and other volt free controls.

Additionally, and aside from controlling individual channels it allows group control of Zone and Category.

It also incorporates advanced control features of Scene, Sequence, Timer and Event.

| DEVICE FEATURES

Provides 2 x digital output channels.

Support integration of curtains, blinds, projector screens/lifts and other digital input triggered devices.

Compact design for convenient installation.

Provides integration with security and safety systems.

Supports Zone, Category, Scene, Sequence, Timer and Event control.

Incorporates Zone and Category grouping.

Built-in Scene, Sequence and Timer engines supporting up to 32 Scenes, 8 Sequences and 16 Timers.

Built-in Event engine supporting up to 32 Events with up to 8 triggers, 8 conditions and 128 actions.

32 Flags can be defined to be used as triggers and/or conditions for Event engine.

Programmable onsite or offsite via Smart IoT CONTROLS Configuration Client Software.

Programmed variables are stored in nonvolatile memory and are retained in case of loss of mains or GreenBUS power.

Supports online upgrade.

CE & RoHs certified.

TECHNICAL SPECIFICATIONS

Operation Voltage:	DC 24V ±10% (BUS Powered)
Power Consumption:	20mA ±10%
Channel:	2 Digital outputs
Working Temperature:	0°C ~ +55°C
Storage Temperature:	-10°C ~ +55°C
Working Humidity:	20% ~ 90%
Storage Humidity:	10% ~ 90%
Color:	Grey
Installation:	Back box or others
Device Dimension:	40x46x13mm (WxHxD)
Packing Dimension:	50x55x35mm (WxHxD)
Net Weight:	20g
Gross Weight:	32g
Operation and Display:	Green LED, for displaying the physical status
CE Mark:	In accordance with EMC and LVD
Protection Class:	IP20, EN60 529

DIMENSIONS

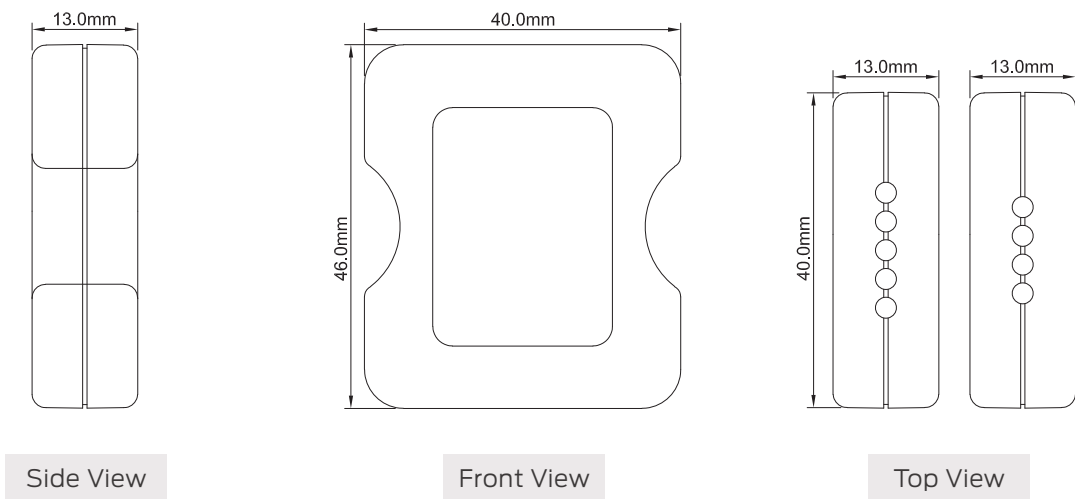

I INSTALLATION

Step 1: Option 1

The device can be installed in numerous locations and its small and compact design makes it ideal for installation into in-wall or surface mounted back boxes (see Figure 1).

Step 1: Option 2

Additionally, other installation methods are allowed as required by the solution's design.

Step 2:

Wire remaining terminals in accordance with wiring diagram (see Figure 2).

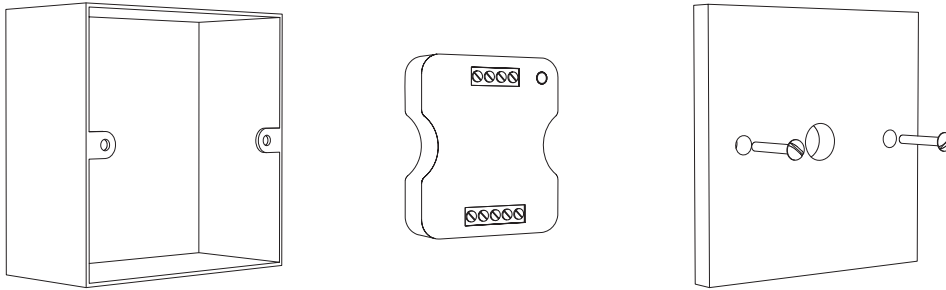

Figure 1

WIRING DIAGRAM

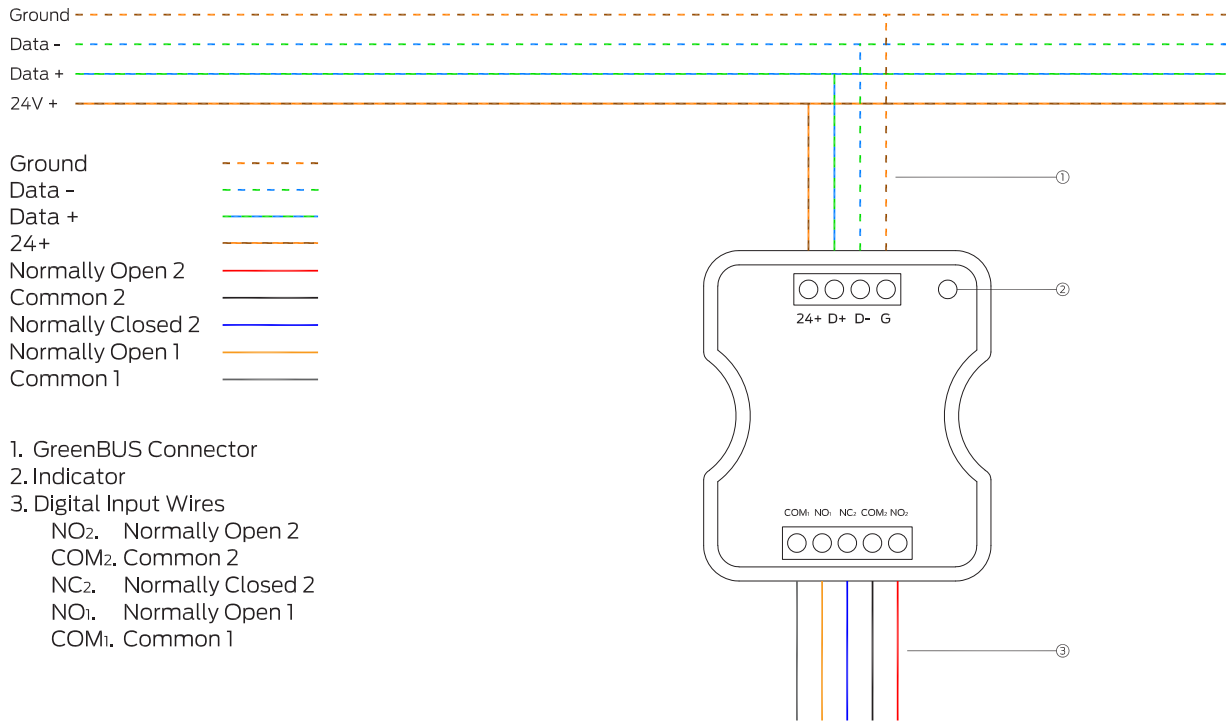

Figure 2: Wiring Diagram

I RECOMMENDED CABLES

Module power input cable:

2.0mm² electrical copper wire.

Load output wire:

2.0mm² electrical copper wire.

Recommended cable configuration:

- GND = Brown and White + Orange and White
- B-(B)= Blue and White + Green and White
- B+(A)= Blue + Green
- 24V = Brown + Orange

